



**NORTH EAST DERBYSHIRE DISTRICT COUNCIL**

**RECORD OF DECISION TAKEN BY THE DIRECTOR OF GROWTH**

**DATE:** 15 November 2021

**STREET NAME AND NUMBERING REF:** 21/07005/SNN

**NAMING OF STREET:** Land Off Chesterfield Road Temple Normanton Chesterfield Derbyshire S42  
5DF

<b>Authority for Decision</b>	<b>Decision</b>	<b>Reasons</b>	<b>Alternative options considered and</b>	<b>Conflicts of interest and any dispensati</b>
<p>9. General powers delegated to all Strategic Directors and Heads of Service.</p> <p>9.1 To exercise within approved budgets all matters of day to day administration and operational management of the services and functions for which they are responsible</p>	<p>To Approve the naming of following Street:</p> <p>1. Williams Way</p>	<p>Currently unnamed</p>	<p>None</p>	<p>None</p>

Please complete the following where relevant:

<b>Key Decision?</b>	<b>Confidential/ Exempt (if yes, please state paragraph)?</b>	<b>Do General Exception or Special Urgency Rules apply to this decision?</b>	<b>Consultation has taken place with the Section 151 &amp; Monitoring Officer?</b>	<b>The Leader, Deputy Leader or relevant Portfolio Member have been consulted?</b>
No	No	No	Yes	Yes

Authorising Signature: .. *Sue Callaghan*

Job title: .Director of Growth.....

Unique Reference Number: .DD/086/21/DBCP.....

Date decision may be implemented following call in (if necessary): .....

Circulation to:

- Head of Paid Services
- Monitoring Officer
- Section 151 Officer
- Scrutiny Officer
- Internal Audit



21/07005/SNN

Land off Chesterfield Road Temple Normanton



Reproduced from the Ordnance Survey map with permission of the Controller of Her Majesty's Stationery Office © Crown Copyright . All rights reserved.  
Chesterfield Borough Council 100018505 (2010)  
Unauthorised reproduction infringes Crown Copyright and may lead to prosecution or civil proceedings.

Date 27/09/2021  
SLA 100018505  
Scale 1:1,250

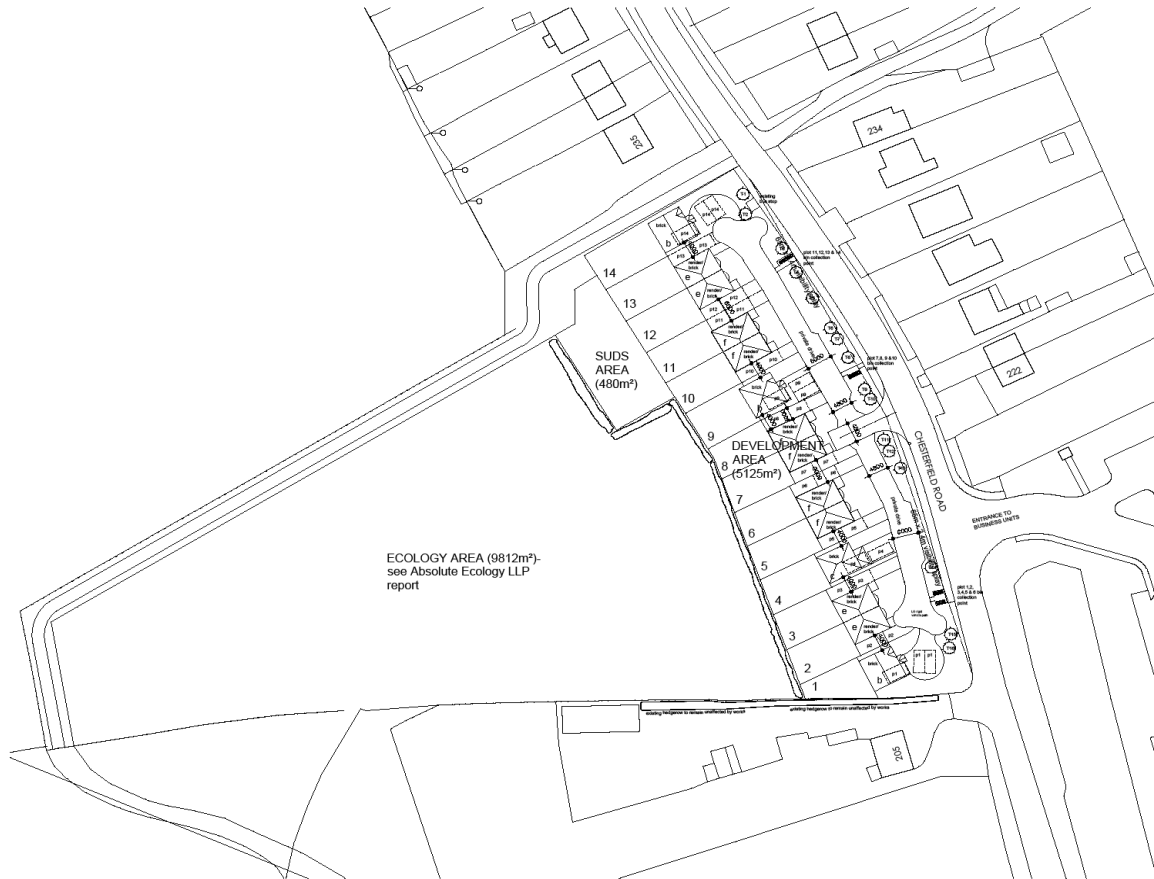

**SITE PLAN**  
Scale 1:500

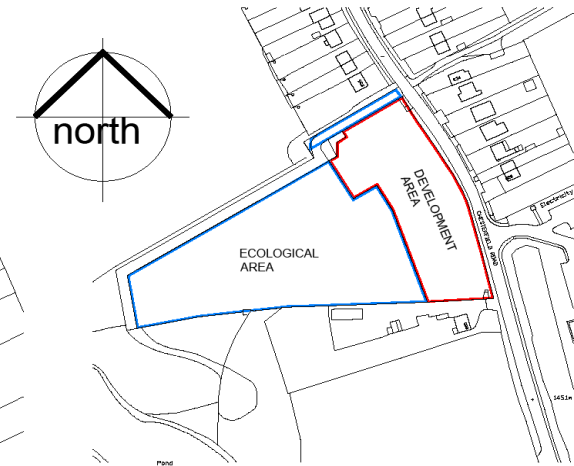

**LOCATION PLAN**  
Scale 1:1250

Rev. R	By: NT	Date: 15/06/2020
House Type F added. Widths between some plots increased.		
Rev. Q	By: NT	Date: 19/03/2019
Private drive widened to 6m in front of plots 3, 4, 5 & 8, 9, 10. Drive widths shown.		
Rev. P	By: NT	Date: 04/02/2019
Turning head and private drive amended to show delivery truck not encroaching on private gardens. Bin collection point for plots 7, 8 & 10 relocated outside visibility splay.		
Rev. O	By: NT	Date: 04/02/2019
Turning head amended to accommodate delivery truck turning geometry.		
Rev. N	By: NT	Date: 16/01/2019
Hipped roof shown to Plots 4 & 9.		
Rev. M	By: NT	Date: 15/01/2019
Site plan amended following planning comments.		
Rev. L	By: NT	Date: 17/12/2018
Site plan amended to include semi-detached types.		
Rev. K	By: NT	Date: 26/10/2018
Minor amendments.		
Rev. J	By: NT	Date: 24/10/2018
Plot numbering revised, additional planting shown to frontage, SUDS area shown.		
Rev. I	By: NT	Date: 18/10/2018
Developable site area reduced.		
Rev. H	By: NT	Date: 12/02/2018
House types updated to latest plans.		
Rev. G	By: NT	Date: 04/01/2018
Bin collection points shown for Plots 1, 2, 3, 4, 10, 11 & 12.		
Rev. F	By: NT	Date: 04/01/2018
Road re-aligned following 'Inspire' comments.		
Rev. E	By: NT	Date: 28/12/2017
Road re-aligned following 'Inspire' comments.		
Rev. D	By: NT	Date: 08/12/2017
Plots 4 & 5 amended following client comments.		
Rev. C	By: NT	Date: 30/11/2017
Site entrance amended following 'Inspire' comments, amendments to scheme.		
Rev. B	By: NT	Date: 21/11/2017
Site boundaries amended following addition of Topographical Survey information.		
Rev. A	By: NT	Date: 16/11/2017
Site area reduced following 'Absolute Ecology' report and recommendations.		

**DRAWING TITLE**  
**PROPOSED SITE PLAN**

PROJECT  
RESIDENTIAL DEVELOPMENT  
AT  
**CHESTERFIELD ROAD**  
**TEMPLE NORMANTON**  
**S42 5DE**

FOR  
**TGN CONSTRUCTION LTD**

PROJECT NO	DRAWING NO	REVISION
118	01	R

SCALE (A1)	DATE	STATUS	DRAWN
1:500	MAY 2017	PRELIM	NT

**7hills**  
architectural  
design ltd

neil bligg  
m: 0197 2885798  
e: This@architecturaldesign.com

Queens Tower Lodge  
77-79 East Bank Road  
Sheffield  
S2 3PX